

PoE Kit QUICK GUIDE

Version: V1.04 BOM: 3101C0N1



3101C0N1151039104

DISCLAIMER

- Thank you for choosing our product. Please contact your local dealer if you have any questions or feedback.
- No part of this manual may be copied, reproduced, translated, or distributed in any form or by any means without prior consent in writing from our company.
- Contents of this manual are subject to change without prior notice.
- No statement, information, or recommendation in this manual shall constitute formal guarantee of any kind, expressed or implied.

SAFETY INFORMATION

- Read through this guide carefully before you start.
- Installation and maintenance must be performed by qualified personnel.
- This device is a class A product and may cause radio interference. Take measures if necessary.
- Make sure the device is stably installed and has clear ventilation. Do not stack devices.
- Ensure a proper operating environment, including temperature, humidity, ventilation, power supply, and lightning protection. The device must always be properly grounded. Keep the device from dust, excessive vibration, liquid of any kind, and strong electromagnetic radiation.
- Protect the power cables, plugs, and sockets so they won't be accidentally stepped on or pressed.
- Make sure the devices are properly connected after completing the installation. Incorrect connection may cause personal injury and device damage. Do not stack devices.
- A sudden power failure may cause damage or malfunction. Use a UPS if possible.
- Keep water and liquid of any kind from entering the device.
- Dispose of the used battery according to local regulations or the battery manufacturer's instructions. Improper use or replacement of the battery may cause risk of explosion. Never dispose of the battery in fire.

2

REGULATORY COMPLIANCE

FCC STATEMENT

This device complies with Part 15 of the FCC Rules. Operation is subject to the following two conditions: (1) this device may not cause harmful interference, and (2) this device must accept any interference received, including interference that may cause undesired operation.

Caution: The user is cautioned that changes or modifications not expressly approved by the party responsible for compliance could void the user's authority to operate the equipment.

Note: This equipment has been tested and found to comply with the limits for a Class A digital device, pursuant to part 15 of the FCC Rules. These limits are designed to provide reasonable protection against harmful interference when the equipment is operated in a commercial environment. This equipment generates, uses, and can radiate radio frequency energy and, if not installed and used in accordance with the instruction manual, may cause harmful interference to radio communications. Operation of this equipment in a residential area is likely to cause harmful interference in which case the user will be required to correct the interference at his own expense.

LVD/EMC DIRECTIVE

This product complies with the European Low Voltage Directive 2014/35/EU and EMC Directive 2014/30/EU.

WEEE DIRECTIVE-2012/19/EU

The product this manual refers to is covered by the Waste Electrical & Electronic Equipment (WEEE) Directive and must be disposed of in a responsible manner.

BATTERY DIRECTIVE-2013/56/EC

Battery in the product complies with the European Battery Directive 2013/56/EC. For proper recycling, return the battery to your supplier or to a designated collection point.

3

DEFAULT SETTINGS

Device	IP Address	Username/Password
NVR	192.168.1.30	admin/123456
Camera	192.168.1.13	admin/123456

APPEARANCE (Take only one device as an example)

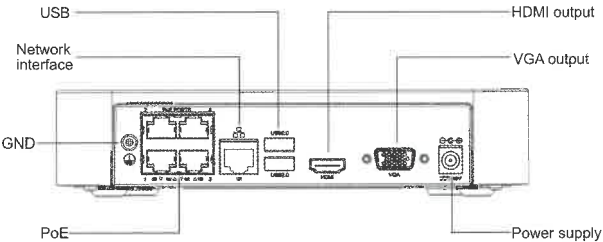

INSTALL HARD DISK

Prepare a Phillips screwdriver (1# or 2#). Please contact your dealer for specifications of compatible hard disks.

Make sure power is disconnected before you start. Wear antistatic gloves or wristband throughout installation.

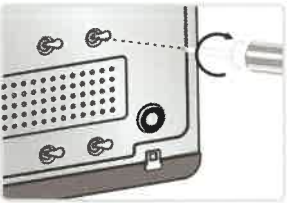

① Remove the cover, connect data and power cables to disk, and then secure disk with screws.

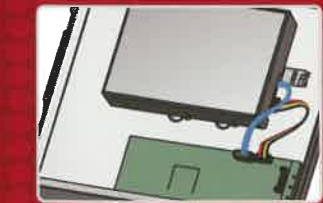

② Connect data and power cables to the motherboard and then install the cover.

5

CONNECTION

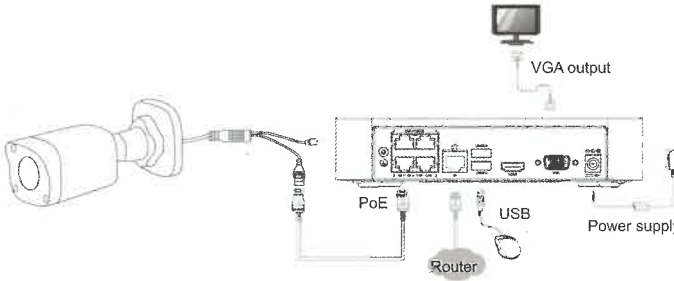

This illustration is for reference only.

CONNECT THE KIT

The NVR can power the camera through its PoE port. You don't have to connect the camera to other power source.

1. Connect the NVR to a monitor with a VGA or HDMI cable (not included in the kit). You may skip this step if you view video only on you mobile phone.
2. Connect the camera to a PoE port on the NVR with a network cable.
3. Plug in a USB mouse on the NVR.
4. Connect the NVR to a router with a network cable.
5. Connect the NVR to power.

6

4